

# Inquiry Form

## Power Mill

Company:

First name:

last name:

Gender:  Mr.  Ms.

Country:

Tel:

E-mail:

The following information should be checked while discussing with customer.

| Machine                |  | Current tool  |                   |
|------------------------|--|---------------|-------------------|
| Spindle Speed          | Max. r.p.m.  | Cutting Speed | m/min. SFM        |
| Power of Spindle motor | <input type="checkbox"/> KW <input type="checkbox"/> HP  | Feed Rate     | mm/rev. inch/rev. |
| Coolant supply         | <input type="checkbox"/> NO <input type="checkbox"/> If yes, <input type="checkbox"/> External <input type="checkbox"/> Internal |               |                   |

### ER Taper-shank dimensions:

(\* MOQ: 2 pcs / Lead Time: 10 ~ 12 Weeks. )

|  |  |
|--|--|
| <b>Cutter Dia.:</b> (ØDc)                        | (Ø10 ~ Ø32)  |
| <b>L1 :</b><br>(See chart for Max.)              |  |
| <b>Center Coolant:</b>                           | <input type="checkbox"/> Yes <input type="checkbox"/> No   |
| <b>ER Nut :</b>                                  | <input type="checkbox"/> N9ER16-M19<br><input type="checkbox"/> N9ER16-M22<br><input type="checkbox"/> N9ER20-M25<br><input type="checkbox"/> N9ER25-M32 |
| <b>Current Insert:</b> ( Please provide sample.) |  |
| Insert Brand:                                    | ISO Code:  |

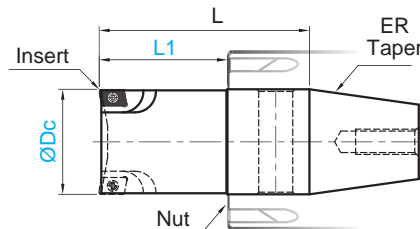

#### • Specifications

| ØDc     | L1 Max. | L Max. | ER Taper |
|---------|---------|--------|----------|
| 10 ~ 32 | 22      | 34     | ER16     |
|         | 26.5    | 40     | ER20     |
|         | 30.5    | 50     | ER25     |

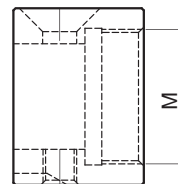

| Nut  | M          |
|------|------------|
| ER16 | M19 x P1.0 |
| ER16 | M22 x P1.5 |
| ER20 | M25 x P1.5 |
| ER25 | M32 x P1.5 |



Please send your request to:  
[trade@jimmore.com.tw](mailto:trade@jimmore.com.tw)  
 Fax: +886-4-22605352.